



# JBL PROFLORA u504

CO2 fertiliser system complete kit for aquarium plants

Suitable for:



- CO2 fertiliser system for the best feeding of fast and slow growing plants in freshwater aquariums from 20 to 400 l
- Professional water care: precise dosing with pressure reducer. Even release, effective distribution due to ceramic diffuser. Monitoring: bubble counter with backflow stop and CO2/pH test
- The conversion to a refillable cylinder system is possible by screwing on the adapter (JBL Adapt u-m, separately available)
- Disposable storage cylinder. No slipping of hose thanks to hose screw connection, check valve prevents water entering the cylinder
- Package contents: 500 g disposable CO2 cylinder, pressure reducer, 3 m hose, bubble counter with check valve, ceramic diffuser, permanent test with reagents, 1x plant fertiliser 100 ml, 1x daily fertiliser 10 ml

You may also be interested in

You can find a complete overview here: <https://www.jbl.de/qr/60640>



**JBL PROFLORA m501**  
CO2 plant fertiliser system  
complete kit



**JBL PROFLORA m502**  
CO2 plant fertiliser system with  
night switch-off



**JBL PROFLORA m503**  
Aquarium plant fertiliser  
system with pH control



**JBL PROFLORA m2003**  
Plant fertiliser system & 2 kg  
cylinder & pH control



# JBL PROFLORA u504

## Accessories



**JBL PROFLORA Direct**  
High performance direct diffuser for CO<sub>2</sub>



**JBL PROFLORA pH-Control Touch**  
Measurement and control computer for control of CO<sub>2</sub>/pH



**JBL PROFLORA Adapt u-m**  
Conversion adapter for the change over from disposable to refillable cylinder system



**JBL PROFLORA 3 x u500**  
CO<sub>2</sub> disposable storage cylinder



**JBL PROFLORA u500**  
500 g disposable CO<sub>2</sub> storage cylinder



**JBL PROFLORA CO<sub>2</sub> Count Safe**  
Bubble counter with backflow stop



**JBL PROFLORA SafeStop**  
Water backflow stop for CO<sub>2</sub> systems



**JBL PROFLORA T3**  
Special hose for CO<sub>2</sub> systems in aquariums



**JBL PROFLORA v002**  
Noiseless solenoid valve



**JBL PROFLORA Taifun Extend**  
Extension for CO<sub>2</sub> high-performance diffuser



**JBL PROFLORA Taifun M**  
CO<sub>2</sub> high-performance diffuser



**JBL PROFLORA Taifun S**  
Extendable CO<sub>2</sub> diffuser for small aquariums



# JBL PROFLORA u504



Accessories



## JBL PROFLORA Taifun P

Mini CO2 diffuser for nano  
freshwater aquariums



# JBL PROFLORA u504



Spare parts

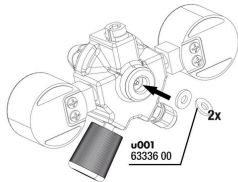

JBL ProFlora "u" flat seal

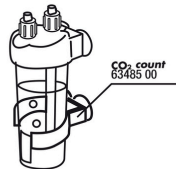

JBL CO2 Count/  
Permanent test  
suction cup + clip

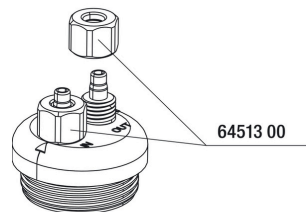

JBL Cap Nut Air/CO<sub>2</sub>  
hose

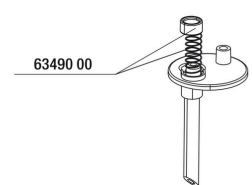

JBL CO2 Count safe  
spring + seal

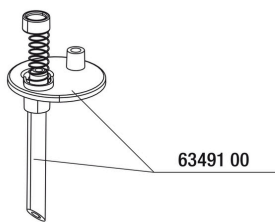

JBL CO2 Count safe  
retaining plate

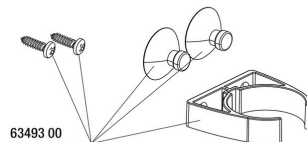

JBL CO2 Count safe  
holder kit

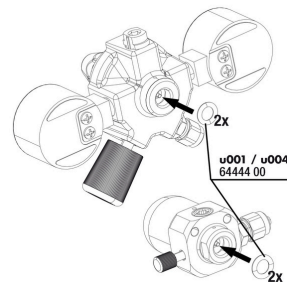

JBL ProFlora "u" O-ring  
seal

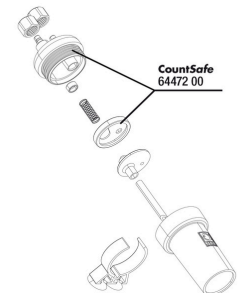

JBL CO2 Count safe  
seal plate

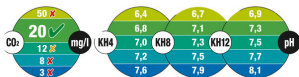

JBL CO2 Permanent  
colour charts

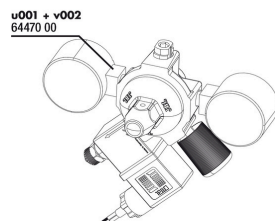

JBL ProFlora u001+  
v002

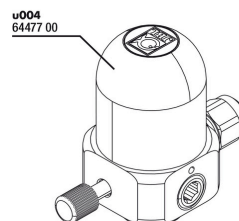

JBL ProFlora u504  
pressure reducer u004



JBL ProFlora Allen key  
6mm





# JBL PROFLORA u504



Spare parts

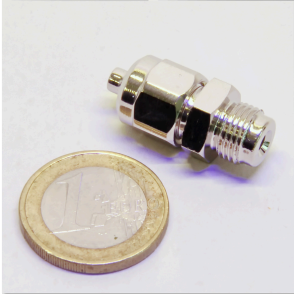

JBL tube screw  
connection 4/6  
pressure reducer

X JBL Clipsauger 6mm



# JBL PROFLORA u504



## Product information

### Nutrition for aquarium plants

Plants provide the aquarium with vital oxygen for your aquarium inhabitants, prevent algae growth, remove pollutants, provide hiding places and reduce pathogens. The JBL plant fertiliser system supplies the plants with the main nutrient CO<sub>2</sub> through the water. The plants absorb this through their leaves.

### Easy to install

The system comes completely ready for connection. Screw the pressure reducer onto the CO<sub>2</sub> storage cylinder. Connect the pressure reducer with the hose to the diffuser in the aquarium. CO<sub>2</sub> thus enters the aquarium and is dissolved in the water with the help of the diffuser. The CO<sub>2</sub> supply can be interrupted at night by an interposed solenoid valve (not included).

### Safe

The storage cylinder is equipped with an overpressure relief. A check valve means no water can enter the cylinder. The capacity of a CO<sub>2</sub> system depends on several factors. The carbonate hardness, the quantity and species of the plants and the strength of the water surface movement are decisive. In its default adjustment a 500 g cylinder not switched off by a solenoid valve during the night lasts for about 4 months.

| Further information   |   |
|-----------------------|---|
| FAQ                   | ✓   |
| Blog                  | ✓   |
| Press                 | ✓   |
| Laboratory/calculator | ✗   |
| Worth reading         | ✓   |
| Spare parts           | ✓   |
| Video                 | ✓   |
| GarantiePlus          | ✗   |
| Instructions          | ✓   |
| QR code               |  |



# JBL PROFLORA u504

|                  |   |
|------------------|---|
| Food type        | - |
| Sub product type | - |
| Dosing           | - |



# JBL PROFLORA u504

## Safety information

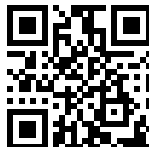
| Further safety information |  |
|----------------------------|--|
| Safety instructions        | ✓  |
| QR code                    |  |