



JBL PROFLORA u504

CO2 fertiliser system complete kit for aquarium plants

Suitable for:



- CO2 fertiliser system for the best feeding of fast and slow growing plants in freshwater aquariums from 20 to 400 l
- Professional water care: precise dosing with pressure reducer. Even release, effective distribution due to ceramic diffuser. Monitoring: bubble counter with backflow stop and CO2/pH test
- The conversion to a refillable cylinder system is possible by screwing on the adapter (JBL Adapt u-m, separately available)
- Disposable storage cylinder. No slipping of hose thanks to hose screw connection, check valve prevents water entering the cylinder
- Package contents: 500 g disposable CO2 cylinder, pressure reducer, 3 m hose, bubble counter with check valve, ceramic diffuser, permanent test with reagents, 1x plant fertiliser 100 ml, 1x daily fertiliser 10 ml



You may also be interested in

You can find a complete overview here: <https://www.jbl.de/qr/60640>



JBL PROFLORA m501
CO2 plant fertiliser system
complete kit



JBL PROFLORA m502
CO2 plant fertiliser system with
night switch-off



JBL PROFLORA m503
Aquarium plant fertiliser
system with pH control



JBL PROFLORA m2003
Plant fertiliser system & 2 kg
cylinder & pH control





JBL PROFLORA u504

Accessories



JBL PROFLORA Direct
High performance direct
diffuser for CO₂



**JBL PROFLORA pH-
Control Touch**
Measurement and control
computer for control of CO₂/
pH



**JBL PROFLORA Adapt
u-m**
Conversion adapter for the
change over from disposable
to refillable cylinder system



**JBL PROFLORA 3 x
u500**
CO₂ disposable storage
cylinder



JBL PROFLORA u500
500 g disposable CO₂ storage
cylinder



**JBL PROFLORA CO₂
Count Safe**
Bubble counter with backflow
stop



**JBL PROFLORA
SafeStop**
Water backflow stop for CO₂
systems



JBL PROFLORA T3
Special hose for CO₂ systems
in aquariums



JBL PROFLORA v002
Noiseless solenoid valve



**JBL PROFLORA Taifun
Extend**
Extension for CO₂ high-
performance diffuser



**JBL PROFLORA Taifun
M**
CO₂ high-performance diffuser



JBL PROFLORA Taifun S
Extendable CO₂ diffuser for
small aquariums



JBL PROFLORA u504

 Accessories



JBL PROFLORA Taifun P
Mini CO2 diffuser for nano
freshwater aquariums



JBL PROFLORA u504

Spare parts

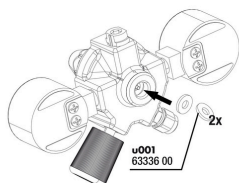

JBL ProFlora "u" flat seal

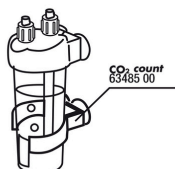

JBL CO2 Count/
Permanent test
suction cup + clip

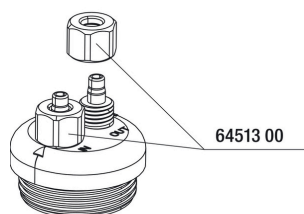

JBL Cap Nut Air/CO₂
hose

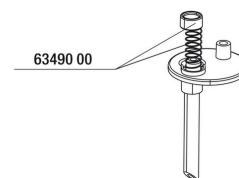

JBL CO2 Count safe
spring + seal

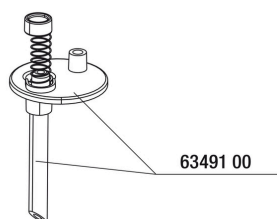

JBL CO2 Count safe
retaining plate

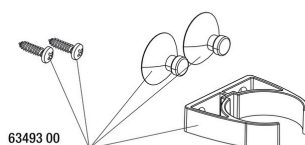

JBL CO2 Count safe
holder kit

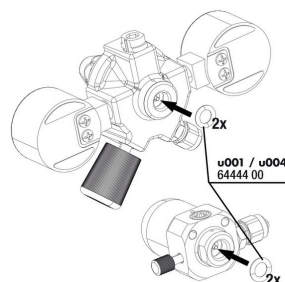

JBL ProFlora "u" O-ring
seal

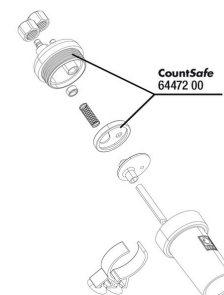

JBL CO2 Count safe
seal plate

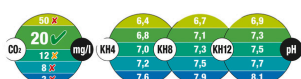

JBL CO2 Permanent
colour charts

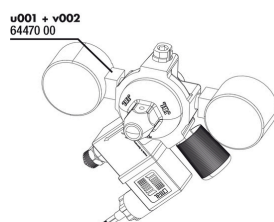

JBL ProFlora u001+
v002

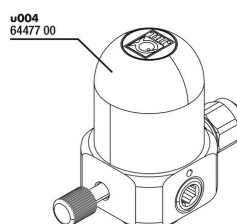

JBL ProFlora u504
pressure reducer u004



JBL ProFlora Allen key
6mm



JBL PROFLORA u504



Spare parts

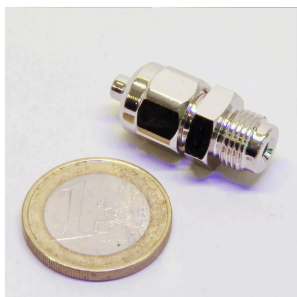

JBL tube screw
connection 4/6
pressure reducer

X JBL Clipsauger 6mm



JBL PROFLORA u504



Product information

Nutrition for aquarium plants

Plants provide the aquarium with vital oxygen for your aquarium inhabitants, prevent algae growth, remove pollutants, provide hiding places and reduce pathogens. The JBL plant fertiliser system supplies the plants with the main nutrient CO₂ through the water. The plants absorb this through their leaves.

Easy to install

The system comes completely ready for connection. Screw the pressure reducer onto the CO₂ storage cylinder. Connect the pressure reducer with the hose to the diffuser in the aquarium. CO₂ thus enters the aquarium and is dissolved in the water with the help of the diffuser. The CO₂ supply can be interrupted at night by an interposed solenoid valve (not included).

Safe

The storage cylinder is equipped with an overpressure relief. A check valve means no water can enter the cylinder. The capacity of a CO₂ system depends on several factors. The carbonate hardness, the quantity and species of the plants and the strength of the water surface movement are decisive. In its default adjustment a 500 g cylinder not switched off by a solenoid valve during the night lasts for about 4 months.

Further information	
FAQ	✓
Blog	✓
Press	✓
Laboratory/calculator	✗
Worth reading	✓
Spare parts	✓
Video	✓
GarantiePlus	✗
Instructions	✓
QR code	



JBL PROFLORA u504

Food type	-
Sub product type	-
Dosing	-



JBL PROFLORA u504



Safety information

Further safety information	
Safety instructions	✓
QR code	