



JBL PROFLORA u501

Plant fertiliser system complete kit

Suitable for:



- CO2 fertiliser system for best feeding of fast and slow growing plants in freshwater aquariums up to 400 l (max. 120 cm)
- Assemble system, attach diffuser in the aquarium and adjust CO2 supply that way that the permanent test indicates optimum value
- Professional water care: precise dosing with pressure reducer. Even release, effective distribution due to extendable diffuser. Monitoring: bubble counter with backflow stop and CO2/pH test. Residual pressure display on pressure gauge
- A hose screw connection means the hose cannot slip, a check valve prevents water entering the cylinder
- Package contents: ProFlora u501, incl. disposable 500g CO2 cylinder, fitting, pressure reducer, diffuser JBL Taifun, bubble counter, 3 m special hose, backflow stop, permanent test CO2/pH, 2x 100 ml liquid fertiliser, 1x JBL daily fertiliser

You may also be interested in

You can find a complete overview here: <https://www.jbl.de/qr/63181>



JBL PROFLORA m501
CO2 plant fertiliser system
complete kit



JBL PROFLORA m502
CO2 plant fertiliser system with
night switch-off



JBL PROFLORA m503
Aquarium plant fertiliser
system with pH control



JBL PROFLORA m2003
Plant fertiliser system & 2 kg
cylinder & pH control





JBL PROFLORA u501

Accessories



JBL Suction cup with clip 37 mm
Rubber suction cup with clip for objects of 37-45 mm



JBL PROFLORA Direct
High performance direct diffuser for CO₂



JBL PROFLORA pH-Control Touch
Measurement and control computer for control of CO₂/pH



JBL PROFLORA Adapt u-m
Conversion adapter for the change over from disposable to refillable cylinder system



JBL PROFLORA 3 x u500
CO₂ disposable storage cylinder



JBL PROFLORA u500
500 g disposable CO₂ storage cylinder



JBL PROFLORA CO₂ Count Safe
Bubble counter with backflow stop



JBL PROFLORA SafeStop
Water backflow stop for CO₂ systems



JBL PROFLORA T3
Special hose for CO₂ systems in aquariums



JBL PROFLORA v002
Noiseless solenoid valve



JBL PROFLORA Taifun Extend
Extension for CO₂ high-performance diffuser



JBL PROFLORA Taifun M
CO₂ high-performance diffuser



JBL PROFLORA u501

Accessories



JBL PROFLORA Taifun S
Extendable CO2 diffuser for
small aquariums



JBL PROFLORA Taifun P
Mini CO2 diffuser for nano
freshwater aquariums



JBL PROFLORA u501

Spare parts

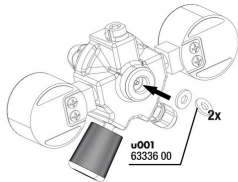

JBL ProFlora "u" flat seal

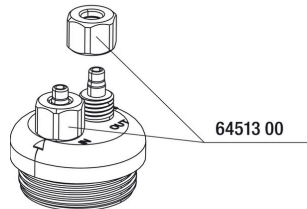

JBL Cap Nut Air/CO2 hose

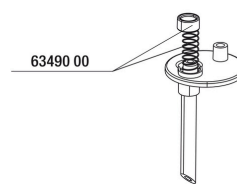

JBL CO2 Count safe spring + seal

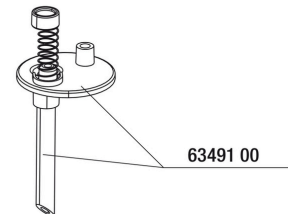

JBL CO2 Count safe retaining plate

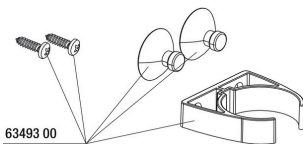

JBL CO2 Count safe holder kit

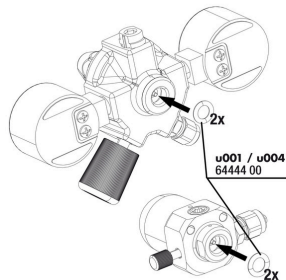

JBL ProFlora "u" O-ring seal

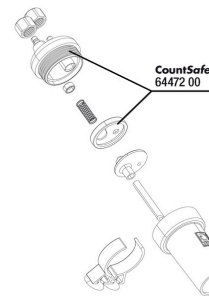

JBL CO2 Count safe seal plate

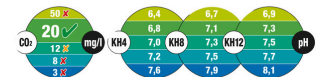

JBL CO2 Permanent colour charts

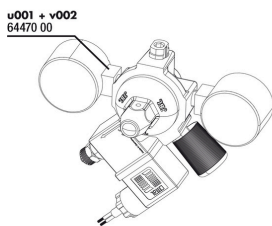

JBL ProFlora u001+ v002



JBL ProFlora Allen key 6mm

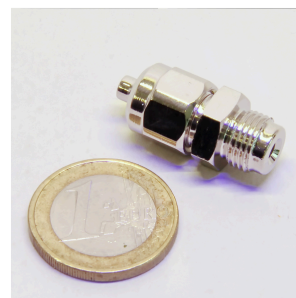

JBL tube screw connection 4/6 pressure reducer



JBL PROFLORA u501



Product information

Nutrition for aquarium plants

Plants supply the aquarium with vital oxygen for your aquarium inhabitants, they prevent algae growth, remove pollutants, provide hiding places and reduce pathogens. The JBL plant fertiliser system supplies the plants with their main nutrient CO₂ through the water. The plants absorb this through their leaves.

Easy to install

The system comes completely ready to connect. Screw the pressure reducer onto the CO₂ storage cylinder. Use the hose to connect the pressure reducer to the diffuser in the aquarium. CO₂ thus enters the aquarium and is dissolved in the water with the help of the diffuser. The CO₂ supply can be interrupted at night by adding an interposed solenoid valve (not included).

Safe

Thanks to the check valve no water can enter the cylinder. The capacity of a CO₂ system depends on various factors. The carbonate hardness, the quantity and species of the plants and the strength of the water surface movement are decisive. A 500 g cylinder which is not switched off by a solenoid valve during the night lasts for about 4 months on its default adjustment.

Further information	
FAQ	✓
Blog	✓
Press	✓
Laboratory/calculator	✗
Worth reading	✓
Spare parts	✓
Video	✓
GarantiePlus	✗
Instructions	✓
QR code	



JBL PROFLORA u501

Food type	-
Sub product type	-
Dosing	-



JBL PROFLORA u501

Safety information

- safety information in accordance with GHS	
Signal word	Warning
Hazard symbol	
Risk phrase	H280: Contains gas under pressure; may explode if heated.
safety note	P101: If medical advice is needed, have product container or label at hand. P102: Keep out of reach of children. P103: Read label before use. P410+P403: Protect from sunlight. Store in a well-ventilated place.

Further safety information	
Safety instructions	✓
QR code	