



# JBL PROFLORA u502

Plant fertiliser system with night switch-off

Suitable for:



- CO2 fertiliser system for the best feeding of fast and slow growing plants in freshwater aquariums up to 600 l (max. 120 cm)
- Assemble system, attach diffuser in the aquarium and adjust CO2 supply that way that the permanent test indicates optimum value
- Professional plant care with night switch-off: precise dosing by means of pressure reducer, even release, effective distribution due to extendable diffuser, best monitoring with bubble counter, CO2/pH test, residual pressure display on pressure gauge
- TÜV tested storage cylinder, hose screw connection prevents hose from slipping, check valve prevents water entering the cylinder
- Package contents: disposable 500 g CO2 cylinder, pressure reducer, night switch-off (time switch sold separately), diffuser, bubble counter with backflow stop, 3 m CO2-proof hose, CO2/pH test, basic and daily fertiliser

You may also be interested in

You can find a complete overview here: <https://www.jbl.de/qr/63182>



**JBL PROFLORA m501**  
 CO2 plant fertiliser system complete kit



**JBL PROFLORA m502**  
 CO2 plant fertiliser system with night switch-off



**JBL PROFLORA m503**  
 Aquarium plant fertiliser system with pH control



**JBL PROFLORA m2003**  
 Plant fertiliser system & 2 kg cylinder & pH control





# JBL PROFLORA u502

## Accessories



**JBL Suction cup with clip 37 mm**  
 Rubber suction cup with clip for objects of 37-45 mm



**JBL PROFLORA Direct**  
 High performance direct diffuser for CO<sub>2</sub>



**JBL PROFLORA pH-Control Touch**  
 Measurement and control computer for control of CO<sub>2</sub>/pH

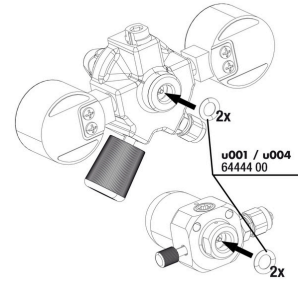

**JBL ProFlora "u" O-ring seal**



**JBL PROFLORA Adapt u-m**  
 Conversion adapter for the change over from disposable to refillable cylinder system



**JBL PROFLORA 3 x u500**  
 CO<sub>2</sub> disposable storage cylinder



**JBL PROFLORA u500**  
 500 g disposable CO<sub>2</sub> storage cylinder



**JBL PROFLORA CO<sub>2</sub> Count Safe**  
 Bubble counter with backflow stop



**JBL PROFLORA SafeStop**  
 Water backflow stop for CO<sub>2</sub> systems



**JBL PROFLORA T3**  
 Special hose for CO<sub>2</sub> systems in aquariums



**JBL PROFLORA v002**  
 Noiseless solenoid valve



**JBL PROFLORA Taifun Extend**  
 Extension for CO<sub>2</sub> high-performance diffuser





# JBL PROFLORA u502

## Accessories



**JBL PROFLORA Taifun M**  
CO2 high-performance diffuser



**JBL PROFLORA Taifun S**  
Extendable CO2 diffuser for  
small aquariums



**JBL PROFLORA Taifun P**  
Mini CO2 diffuser for nano  
freshwater aquariums



# JBL PROFLORA u502

## Spare parts



JBL ProFlora Allen key  
6mm

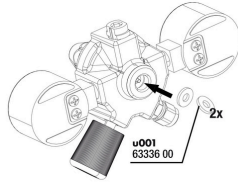

JBL ProFlora "u" flat seal

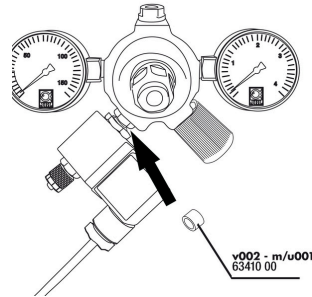

JBL ProFlora "u/m" flat seal



JBL adapter UK for all  
flat-pin plugs

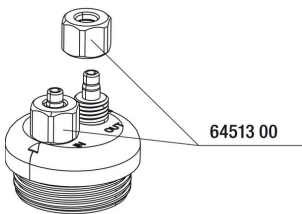

JBL Cap Nut Air/CO<sub>2</sub>  
hose

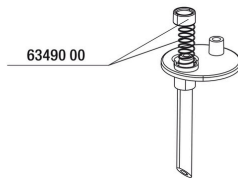

JBL CO2 Count safe  
spring + seal

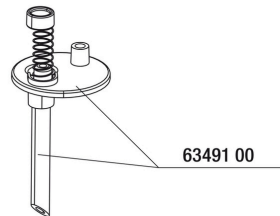

JBL CO2 Count safe  
retaining plate

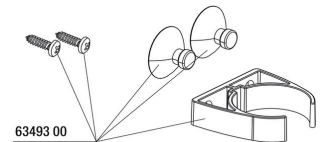

JBL CO2 Count safe  
holder kit



JBL CO2 Count safe  
seal plate



JBL CO2 Permanent  
colour charts

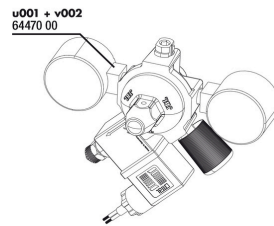

JBL ProFlora u001+  
v002

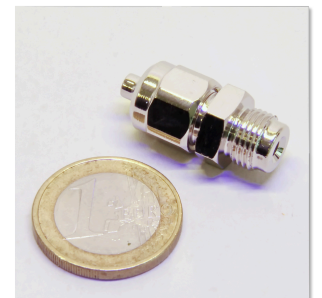

JBL tube screw  
connection 4/6  
pressure reducer





# JBL PROFLORA u502



## Product information

### Nutrition for aquarium plants

Plants provide the aquarium with vital oxygen for the aquarium dwellers, prevent algae growth, remove pollutants, provide hiding places and reduce pathogens. The JBL plant fertiliser system supplies the plants with the main nutrient CO2 through the water. They absorb this through their leaves.

### Easy to install

The system comes completely ready for connection. Screw the pressure reducer onto the CO2 storage cylinder. Connect the pressure reducer with the hose to the diffuser in the aquarium. The CO2 enters the aquarium and is dissolved in the water by the diffuser. The CO2 supply can be interrupted at night by adding a solenoid valve.

### Safe

The storage cylinder is TÜV tested. Thanks to the check valve no water can enter the cylinder. The capacity of a CO2 system depends on various factors. The carbonate hardness, the quantity and species of the plants and the strength of the water surface movement are decisive. A 500 g cylinder which is not switched off by a solenoid valve during the night lasts with its default adjustment for about 4 months.

Further information	
FAQ	✓
Blog	✓
Press	✓
Laboratory/calculator	✗
Worth reading	✓
Spare parts	✓
Video	✓
GarantiePlus	✗
Instructions	✓
QR code	





# JBL PROFLORA u502

Food type	-
Sub product type	-
Dosing	-





# JBL PROFLORA u502



## Safety information

- safety information in accordance with GHS	
Signal word	Warning
Hazard symbol	
Risk phrase	H280: Contains gas under pressure; may explode if heated.
safety note	P101: If medical advice is needed, have product container or label at hand. P102: Keep out of reach of children. P103: Read label before use. P410+P403: Protect from sunlight. Store in a well-ventilated place.

Further safety information	
Safety instructions	✓
QR code	