

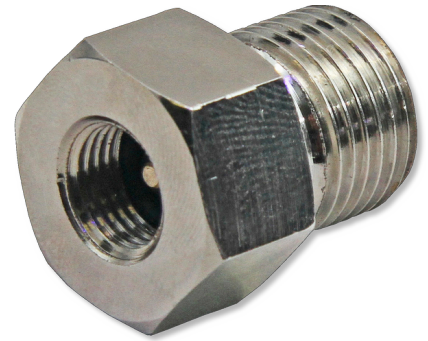

# JBL PROFLORA Adapt u201-u500

Adapter for pressure reducer u201

Suitable for:



- Adapts the pressure reducer u201 (5/8" UNF) to the disposable cylinders u500 (M10 x 1)
- Assembly: screw the adapter into the pressure reducer and then screw the pressure reducer onto the cylinder u500
- Enables the pressure reducer (thread 5/8" UNF) to be screwed onto u500 disposable cylinders with thread M10x1
- Dimensions (l/h/w): 22/24/22 mm
- Package contents: adapter for pressure reducer, ProFlora Adapt u201-u500, from u 201 onto u 500



# JBL PROFLORA Adapt u201-u500



## Product information

Ideal nutrition for plants

Carbon dioxide serves as the main nutrient for plants and thus promotes their ideal growth. Plants use CO<sub>2</sub> for photosynthesis and thus supply the water with essential oxygen. They prevent algae growth, remove pollutants, offer hiding places and reduce pathogens. The correct amount of CO<sub>2</sub> varies from aquarium to aquarium and depends on the volume, the water movement and the planting of the aquarium. With ProFlora Adapt you easily change the pressure reducer over from disposable cylinder u201 to disposable cylinders u500.

Further information	
FAQ	✓
Blog	✓
Press	×
Laboratory/calculator	×
Worth reading	✓
Spare parts	×
Video	✓
GarantiePlus	×
Instructions	×
QR code	



# JBL PROFLORA Adapt u201-u500

Food type	-
Sub product type	-
Dosing	-