



# JBL PROFLORA m603

Plant fertiliser system with pH control device

Suitable for:



- CO2 fertiliser system for the best feeding of fast and slow growing plants in freshwater aquariums from 100 up to 600 l
- Easy use and efficient: refillable 500 g cylinder. Simple assembly, no separate water pump required. Can be converted into disposable system
- Professional water care, automatic control: precise dosing due to pressure reducer. Even releas. Effective distribution due to extendable diffuser. Best check: bubble counter, CO2/pH test. Residual pressure display on pressure gauge
- TÜV tested storage cylinder, pressure cylinder with overpressure relief. Stand ensures cylinder does not fall over. Hose screw connection prevents hose from slipping, check valve prevents water entering the cylinder
- Package contents: CO2 plant fertiliser system ProFlora m602, incl. refillable 500g CO2 cylinder, fitting, stand, pressure reducer, pH control device, diffuser, bubble counter, 2 m hose, backflow stop, KH test



# JBL PROFLORA m603

## Accessories



**JBL Suction cup with clip 37 mm**  
Rubber suction cup with clip for objects of 37-45 mm



**JBL PROFLORA Direct**  
High performance direct diffuser for CO<sub>2</sub>



**JBL PROFLORA pH-Control Touch**  
Measurement and control computer for control of CO<sub>2</sub>/pH



**JBL PROFLORA pH-Sensor+Cal**  
pH electrode with BNC connection



**JBL PROFLORA CO<sub>2</sub> Count Safe**  
Bubble counter with backflow stop



**JBL PROFLORA SafeStop**  
Water backflow stop for CO<sub>2</sub> systems



**JBL PROFLORA T3**  
Special hose for CO<sub>2</sub> systems in aquariums



**JBL PROFLORA stand CO<sub>2</sub> storage cylinder 500 g**  
Stand for cylinders of CO<sub>2</sub> fertiliser systems



**JBL PROFLORA m001**  
Fitting to reduce pressure



**JBL PROFLORA v002**  
Noiseless solenoid valve



**JBL PROFLORA Taifun Extend**  
Extension for CO<sub>2</sub> high-performance diffuser



**JBL PROFLORA Taifun M**  
CO<sub>2</sub> high-performance diffuser





# JBL PROFLORA m603

## Accessories



**JBL PROFLORA Taifun S**  
Extendable CO2 diffuser for  
small aquariums



**JBL PROFLORA Taifun P**  
Mini CO2 diffuser for nano  
freshwater aquariums



# JBL PROFLORA m603

## Spare parts

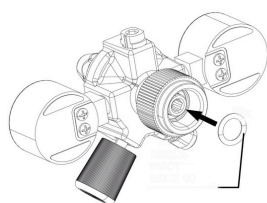

JBL ProFlora "m" O-ring

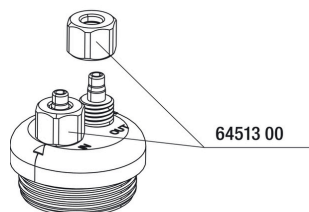

JBL Cap Nut Air/CO<sub>2</sub> hose

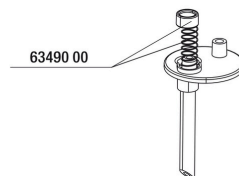

JBL CO<sub>2</sub> Count safe spring + seal

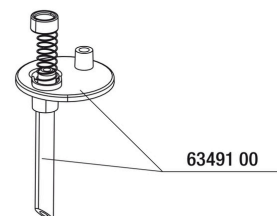

JBL CO<sub>2</sub> Count safe retaining plate

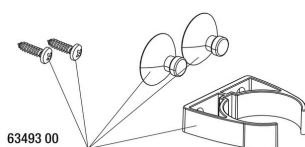

JBL CO<sub>2</sub> Count safe holder kit

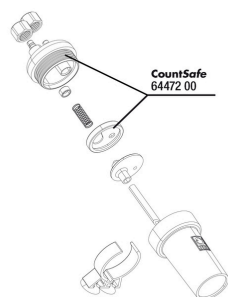

JBL CO<sub>2</sub> Count safe seal plate



JBL CO<sub>2</sub> Permanent colour charts

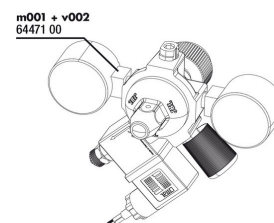

JBL ProFlora m001+ v002



JBL tube screw connection 4/6 pressure reducer





# JBL PROFLORA m603



## Product information

### Nutrition for aquarium plants

Plants provide the aquarium with vital oxygen for the aquarium dwellers, prevent algae growth, remove pollutants, provide hiding places and reduce pathogens. The JBL plant fertiliser system supplies the plants with the main nutrient CO<sub>2</sub> through the water. They absorb this through their leaves.

### Easy to install

The system comes completely ready for connection. Screw the pressure reducer onto the CO<sub>2</sub> storage cylinder. Connect the pressure reducer with the hose to the diffuser in the aquarium. The CO<sub>2</sub> enters the aquarium and is dissolved in the water by the diffuser. The CO<sub>2</sub> supply can be interrupted at night by adding a solenoid valve (not included).

### Safe

The storage cylinder is TÜV tested and is equipped with an overpressure relief. Thanks to the check valve no water can enter the cylinder. The enclosed stand prevents the cylinder from falling over. The capacity of a CO<sub>2</sub> system depends on various factors. The carbonate hardness, the quantity and species of the plants and the strength of the water surface movement are decisive. A 500 g cylinder which is not switched off by a solenoid valve during the night lasts with its default adjustment for about 4 months.

Further information	
FAQ	✓
Blog	✓
Press	✓
Laboratory/calculator	✗
Worth reading	✓
Spare parts	✓
Video	✓
GarantiePlus	✓
Instructions	✓
QR code	



# JBL PROFLORA m603



## Product details

Article data	
Product name	JBL PROFLORA m603
Art. No.	6302200
EAN number	4014162630223
EAN as barcode	
Content	500 g
Range	600 l
Expiry months	-
RRP incl. VAT	-
Base price	-
Nominal filling quantity	-
Base quantity	1
Gross weight	7000 g
Net weight	5620 g
Weight change	1000

Disposal	
Product name	JBL PROFLORA m603
Art. No.	6302200
Green dot	✓
Group electronic waste	X Beleuchtungskörper
Disposal weight	572 g
Battery type	-
Battery return	-
Battery rechargeable	-
Disposal weight battery	-
Non-returnable glass	-
PPK	1380 g
Plastic small	-
Plastic large	-
Disposal weight metal	0 g

Features	
Product name	JBL PROFLORA m603
Art. No.	6302200
Animal species	Arowana, Axolotl, Barbels, Bettas, Bichirs/reedfish, Blowfish, Catfish, Cichlids (South America), Crayfish, Danions, Discus, Dwarf shrimps, Flowerhorn, Goldfish, Gouramis, Guppy, Juvenile fish, Killifish, Livebearers, Loaches, Mussels, Panchaxes, Rainbowfish, Snails, Spiny eels, Tetra, Veiltails, freshwater butterflyfish
Animal size	For all animal sizes



Features	
Animal age group	All aquarium fish
Volume of habitat	600 L
Material	plastic (PC), metal (steel), metal (brass)
Food type	-
Colour	multicoloured
Dosage	-
Transport conditions	Protect from direct sunlight during storage and transport and ensure good ventilation.



# JBL PROFLORA m603

Electronic label / illuminant	
Product name	JBL PROFLORA m603
Art. No.	6302200
Ambient temperature	-
Start time	-
Mercury	-
Tube length	-
Service life	-
Lumen	-
CRI value	-
Dimmable	-
Switching cycles	-
PAR value	-
Energy efficiency class	-
UV-A	-
UV-B	-
UV-C	-
Colour temperature	-
Base designation	-

Technical data	
Product name	JBL PROFLORA m603
Art. No.	6302200
Range in litres	-
Range from - to	100-600
Range in days	-
Range tank length	-
Output in watts	-
Output per hour	-
Output per day	-
Height	-
Length	-
Width	-
Diameter	-
Voltage	-
For	-
T8 26mm (watt)	-
T5 16mm (watt)	-
Size	-
Content for	-
Filter container volume	-
Volume filter media	-
Hose connections pressure/out	-
Hose connections suction/in	-
Delivery head	-



# JBL PROFLORA m603

Food type	-
Sub product type	-
Dosing	-





# JBL PROFLORA m603

## Safety information

- safety information in accordance with GHS	
Signal word	Warning
Hazard symbol	
Risk phrase	H280: Contains gas under pressure; may explode if heated.
safety note	P101: If medical advice is needed, have product container or label at hand. P102: Keep out of reach of children. P103: Read label before use. P410+P403: Protect from sunlight. Store in a well-ventilated place.

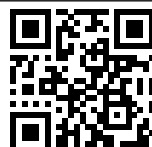
Further safety information	
Safety instructions	✓
QR code	



## Additional information for the specialist trade sector

Article data	
Product name	JBL PROFLORA m603
Art. No.	6302200
VAT	19%
Sales unit (SU)	1
Volume packaging	34.84l
Dimensions (l/w/h)	135 mm/555 mm/465 mm
Layer	11
Pallet	22
Category of products	3
Customs tariff	84811099
Country of origin	DE
Type of packaging	Faltschachtel/Karton

PU 1 data	
Product name	JBL PROFLORA m603
Art. No.	6302200
PU 1 material	None
PU 1 weight	-
PU 1 length	-
PU 1 width/depth	-
PU 1 height	-

PU 2 data	
Product name	JBL PROFLORA m603
Art. No.	6302200
PU 2 material	None
PU 2 weight	-
PU 2 length	-
PU 2 width/depth	-
PU 2 height	-

Trade data	
Product name	JBL PROFLORA m603
Art. No.	6302200
Till receipt text	ProFlora m603
Shelf placement	-