



JBL PROCRISTAL UV-C Compact plus 11 W

Compact UV-C water clarifier against water cloudiness

Suitable for:



JBL		Anwendung / Application / Utilization			
5W	Teich / Pond / Bassin / Vijver	Aquarium		Vol. (l)	(l/h)
		Vol. (l)	(l/h)		
11W	Partial sterilisation	-	-	100 - 300	100 - 300
	Partial sterilisation	-	-	50 - 100	100 - 300
18W	Partial sterilisation	-	-	200 - 800	200 - 500
	Partial sterilisation	-	-	100 - 200	200 - 500
36W	Partial sterilisation	10,000 - 15,000	2,000 - 4,000	800 - 1,500	300 - 500
	Partial sterilisation	2,000 - 4,000	2,000 - 4,000	200 - 400	300 - 500
54W	Partial sterilisation	20,000 - 30,000	2,000 - 4,000	1,500 - 3,000	400 - 1,000
	Partial sterilisation	4,000 - 8,000	2,000 - 4,000	300 - 600	400 - 1,000

- Cristal-clear and healthy water: 11 W UV-C clarifier for the quick and efficient elimination of greenish and whitish cloudiness in freshwater and marine aquariums
- Space-saving assembly: connect to external filter. Inlet and outlet are positioned for practical use. Shortest installation length: 42 cm
- Partial sterilisation for aquariums up to 800 litres (pump max. 500 l/h), to combat floating algae up to 200 l in the aquarium (pump max. 500 l/h). Partial sterilisation reduces the risk of disease. Floating algae turn the water green
- TÜV tested, safety switch: UV-C bulb switches off automatically when the device is opened. Sturdy, UV-resistant casing, 2- glass-cylinder design
- Package contents: complete UV-C device, 2 m cable, UV-C bulb 11 W, socket: G23, wall mount, screws, nozzle hose connections for 16-19 mm hoses. Guarantee: 2 years (+2 years upon registration of the product)





JBL PROCRISTAL UV-C Compact plus 11 W

Accessories



JBL Replacement lamp UV-C

Replacement lamp for UV-C water clarifier



JBL PROCRISTAL UV-C QuickConnect

Connects two JBL ProCristal UV-C water clarifiers



JBL PROCRISTAL UV-C ElbowConnect

90° elbow for JBL ProCristal UV-C devices



JBL ProFlow t300

Submersible pump with 80-300 l/h for water circulation



JBL ProFlow t500

Submersible pump 200-500 l/h for water circulation



JBL ProFlow u800

Universal pump with 900 l/h for circulation of water



JBL ProFlow u1100

Universal pump with 1200 l/h for circulation of water



JBL ProFlow u2000

Universal pump with 2000 l/h for circulation of water



JBL adapter UK for all circular plugs



JBL double stopcock+ quick coupling

For connecting, disconnecting & shutting off hoses



JBL PROCRISTAL UV-C Compact plus 11 W

Spare parts

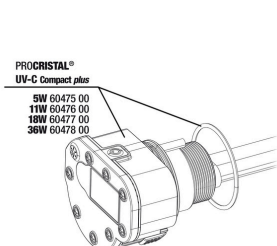

JBL PC UV-C Compact plus electrical unit

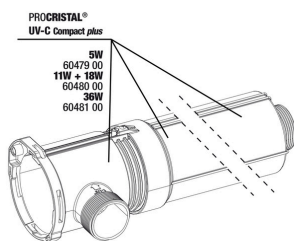

JBL PC UV-C Compact plus casing kit

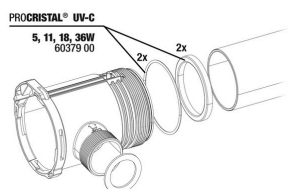

JBL PC UV-C 5,11,18,36 W gasket set

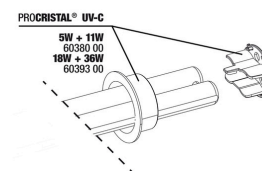

JBL PC UV-C bulb protection kit

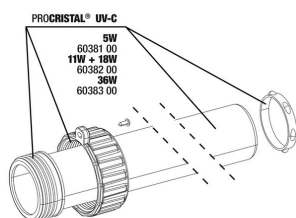

JBL PC UV-C quartz glass cylinder set

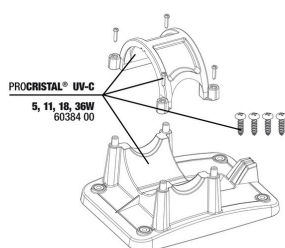

JBL PC UV-C 5,11,18,36 W mounting

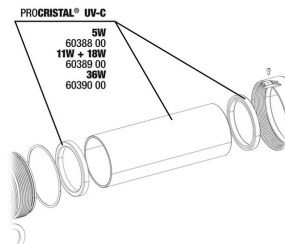

JBL PC UV-C glass sleeve + reflector set

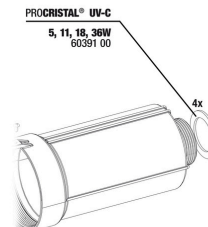

JBL PC UV-C hose connection gaskets

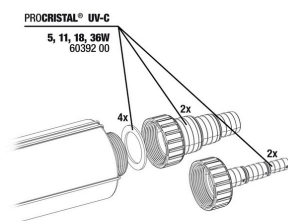

JBL PC UV-C hose connection set



JBL PROCRISTAL UV-C Compact plus 11 W



Product information

Crystal-clear and healthy water

Poor light conditions, over-fertilisation or even a surplus of nutrients can have negative effects on the aquarium water and may promote algae growth. Floating algae lead to green, bacteria to white clouding. The JBL water clarifier eliminates cloudiness caused by bacteria and floating algae. The aquarium water passes through the sturdy, UV-resistant casing of the clarifier. The UV radiation kills off bacteria, other germs and floating algae as the water passes through. The efficiency of this UV-C water clarifier is particularly high, as the glass bulb is surrounded by a polished, reflective stainless steel foil, which reflects the UV-C radiation and thus doubles the efficiency. This can also help to eliminate persistent algae, such as thread algae, since their spores are also largely killed off.

No harmful side effects

No change of the water values / no negative influence on the essential cleansing bacteria in the filter.

Easy to install

Connect the water clarifier to the external filter or a separate water pump. Thanks to the 90° elbow included in the pack any installation position is possible.

Safety

The JBL UV-C Water Clarifier is TÜV tested and has a safety switch for an automatic switch off when the device is opened. The casing is UV-resistant, consists of sturdy walls and has an LED light that indicates whether the UV-C bulb is switched on.

Difference to the previous model JBL ProCristal UV-C Compact:

The function indicator light is now mounted on the flat side of the electrical unit and the microswitch for the automatic switch-off of the burner when the housing is opened (if the plug has not been removed) has been replaced by a magnetic safety switch. This means that the electrical units of the previous models (Compact) do NOT fit the new ones (Compact Plus) and vice versa.

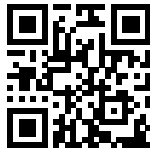
Further information	
FAQ	✓
Blog	✓
Press	✓
Laboratory/calculator	✗
Worth reading	✓
Spare parts	✓
Video	✓
GarantiePlus	✓
Instructions	✓
QR code	



JBL PROCRISTAL UV-C Compact plus 11 W



Product details

Article data	
Product name	JBL PROCRISTAL UV-C Compact plus 36 W
Art. No.	6047100
EAN number	4014162604712
EAN as barcode	
Performance	11 W
Length	36,5 cm
Expiry months	-
RRP incl. VAT	151,83 €
Base price	-
Nominal filling quantity	-
Base quantity	1
Gross weight	2306 g
Net weight	1906 g
Weight change	-

Disposal	
Product name	JBL PROCRISTAL UV-C Compact plus 36 W
Art. No.	6047100
Green dot	✓
Group electronic waste	Small appliances that can be used in private households
Disposal weight	618 g
Battery type	-
Battery return	-
Battery rechargeable	-
Disposal weight battery	-
Non-returnable glass	-
PPK	510 g
Plastic small	-
Plastic large	-
Disposal weight metal	0 g

Features	
Product name	JBL PROCRISTAL UV-C Compact plus 36 W
Art. No.	6047100



Features	
Animal species	Arowana, Axolotl, Barbels, Bettas, Bichirs/reedfish, Blowfish, Catfish, Cichlids (South America), Corals, Crayfish, Danions, Discus, Dwarf crayfish, Dwarf shrimps, Flowerhorn, Gobies, Goldfish, Gouramis, Guppy, Juvenile fish, Killifish, Livebearers, Loaches, Mussels, Newts, Panchaxes, Rainbowfish, Snails, Spiny eels, Tetra, Veiltails, freshwater butterflyfish
Animal size	For all animal sizes
Animal age group	-
Volume of habitat	-
Material	Plastic/glass/copper
Food type	-
Colour	grey / black
Dosage	-
Transport conditions	-



JBL PROCRISTAL UV-C Compact plus 11 W

Electronic label / illuminant	
Product name	JBL PROCRISTAL UV-C Compact plus 36 W
Art. No.	6047100
Ambient temperature	-
Start time	-
Mercury	-
Tube length	-
Service life	-
Lumen	-
CRI value	-
Dimmable	-
Switching cycles	-
PAR value	-
Energy efficiency class	-
UV-A	-
UV-B	-
UV-C	-
Colour temperature	-
Base designation	-

Technical data	
Product name	JBL PROCRISTAL UV-C Compact plus 36 W
Art. No.	6047100
Range in litres	-
Range from - to	-
Range in days	-
Range tank length	-
Output in watts	11 W
Output per hour	-
Output per day	-
Height	141 mm
Length	447 mm
Width	250 mm
Diameter	-
Voltage	240 V
For	-
T8 26mm (watt)	-
T5 16mm (watt)	-
Size	-
Content for	-
Filter container volume	-
Volume filter media	-
Hose connections pressure/out	-



Technical data	
Hose connections suction/in	-
Delivery head	-



JBL PROCRISTAL UV-C Compact plus 11 W

Food type	-
Sub product type	-
Dosing	-



Additional information for the specialist trade sector

Article data	
Product name	JBL PROCRISTAL UV-C Compact plus 36 W
Art. No.	6047100
VAT	25%
Sales unit (SU)	1
Volume packaging	13l
Dimensions (l/w/h)	165 mm/377 mm/210 mm
Layer	24
Pallet	96
Category of products	3
Customs tariff	84212100
Country of origin	CN
Type of packaging	Faltschachtel/Karton

PU 1 data	
Product name	JBL PROCRISTAL UV-C Compact plus 36 W
Art. No.	6047100
PU 1 material	cardboard gr
PU 1 weight	1308 g
PU 1 length	785 mm
PU 1 width/depth	370 mm
PU 1 height	450 mm

PU 2 data	
Product name	JBL PROCRISTAL UV-C Compact plus 36 W
Art. No.	6047100
PU 2 material	None
PU 2 weight	-
PU 2 length	-
PU 2 width/depth	-
PU 2 height	-

Trade data	
Product name	JBL PROCRISTAL UV-C Compact plus 36 W
Art. No.	6047100
Till receipt text	UV-C ComPlus11W
Shelf placement	Technical equipment, water treatment