



JBL PROFLORA u504

CO2 fertiliser system complete kit for aquarium plants

Suitable for:



- CO2 fertiliser system for the best feeding of fast and slow growing plants in freshwater aquariums from 20 to 400 l
- Professional water care: precise dosing with pressure reducer. Even release, effective distribution due to ceramic diffuser. Monitoring: bubble counter with backflow stop and CO2/pH test
- The conversion to a refillable cylinder system is possible by screwing on the adapter (JBL Adapt u-m, separately available)
- Disposable storage cylinder. No slipping of hose thanks to hose screw connection, check valve prevents water entering the cylinder
- Package contents: 500 g disposable CO2 cylinder, pressure reducer, 3 m hose, bubble counter with check valve, ceramic diffuser, permanent test with reagents, 1x plant fertiliser 100 ml, 1x daily fertiliser 10 ml

You may also be interested in

You can find a complete overview here: <https://www.jbl.de/qr/60640>



JBL PROFLORA m501
CO2 plant fertiliser system complete kit



JBL PROFLORA m502
CO2 plant fertiliser system with night switch-off



JBL PROFLORA m503
Aquarium plant fertiliser system with pH control



JBL PROFLORA m2003
Plant fertiliser system & 2 kg cylinder & pH control





JBL PROFLORA u504

Accessories



JBL PROFLORA Direct
 High performance direct diffuser for CO₂



JBL PROFLORA pH-Control Touch
 Measurement and control computer for control of CO₂/pH



JBL PROFLORA Adapt u-m
 Conversion adapter for the change over from disposable to refillable cylinder system



JBL PROFLORA 3 x u500
 CO₂ disposable storage cylinder



JBL PROFLORA u500
 500 g disposable CO₂ storage cylinder



JBL PROFLORA CO₂ Count Safe
 Bubble counter with backflow stop



JBL PROFLORA SafeStop
 Water backflow stop for CO₂ systems



JBL PROFLORA T3
 Special hose for CO₂ systems in aquariums



JBL PROFLORA v002
 Noiseless solenoid valve



JBL PROFLORA Taifun Extend
 Extension for CO₂ high-performance diffuser



JBL PROFLORA Taifun M
 CO₂ high-performance diffuser



JBL PROFLORA Taifun S
 Extendable CO₂ diffuser for small aquariums





JBL PROFLORA u504

Accessories



JBL PROFLORA Taifun P
Mini CO2 diffuser for nano
freshwater aquariums



JBL PROFLORA u504

Spare parts

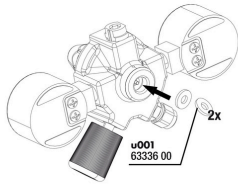

JBL ProFlora "u" flat seal

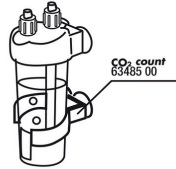

JBL CO2 Count/
Permanent test
suction cup + clip

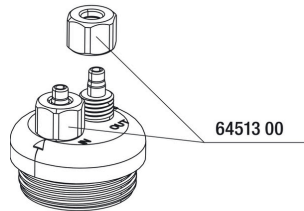

JBL Cap Nut Air/CO₂
hose

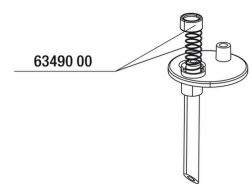

JBL CO2 Count safe
spring + seal

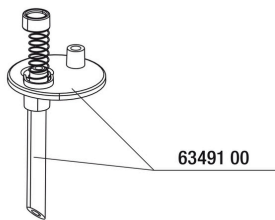

JBL CO2 Count safe
retaining plate

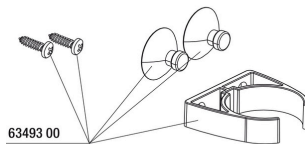

JBL CO2 Count safe
holder kit

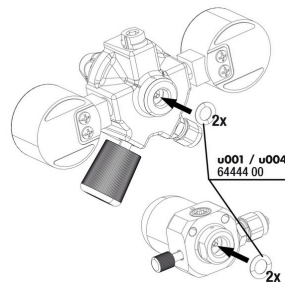

JBL ProFlora "u" O-ring
seal

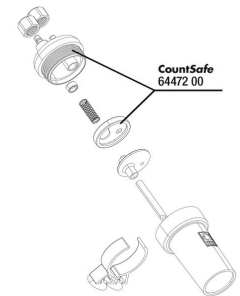

JBL CO2 Count safe
seal plate

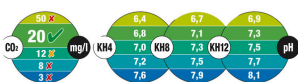

JBL CO2 Permanent
colour charts

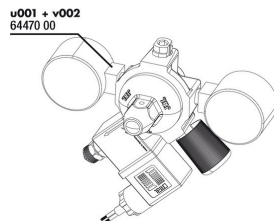

JBL ProFlora u001+
v002

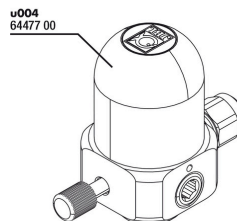

JBL ProFlora u504
pressure reducer u004



JBL ProFlora Allen key
6mm





JBL PROFLORA u504

 Spare parts

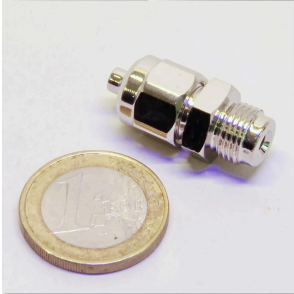

JBL tube screw
connection 4/6
pressure reducer

X JBL Clipsauger 6mm



JBL PROFLORA u504



Product information

Nutrition for aquarium plants

Plants provide the aquarium with vital oxygen for your aquarium inhabitants, prevent algae growth, remove pollutants, provide hiding places and reduce pathogens. The JBL plant fertiliser system supplies the plants with the main nutrient CO2 through the water. The plants absorb this through their leaves.

Easy to install

The system comes completely ready for connection. Screw the pressure reducer onto the CO2 storage cylinder. Connect the pressure reducer with the hose to the diffuser in the aquarium. CO2 thus enters the aquarium and is dissolved in the water with the help of the diffuser. The CO2 supply can be interrupted at night by an interposed solenoid valve (not included).

Safe

The storage cylinder is equipped with an overpressure relief. A check valve means no water can enter the cylinder. The capacity of a CO2 system depends on several factors. The carbonate hardness, the quantity and species of the plants and the strength of the water surface movement are decisive. In its default adjustment a 500 g cylinder not switched off by a solenoid valve during the night lasts for about 4 months.

| Further information | |
|-----------------------|---|
| FAQ | ✓ |
| Blog | ✓ |
| Press | ✓ |
| Laboratory/calculator | ✗ |
| Worth reading | ✓ |
| Spare parts | ✓ |
| Video | ✓ |
| GarantiePlus | ✗ |
| Instructions | ✓ |
| QR code |  |





JBL PROFLORA u504

| | |
|------------------|---|
| Food type | - |
| Sub product type | - |
| Dosing | - |





JBL PROFLORA u504



Safety information

| Further safety information | |
|----------------------------|--|
| Safety instructions | ✓ |
| QR code |  |